

Quick - connects

SQC Series, SFQC Series



INSTRUMENTATION QUICK - CONNECTS

SQC SERIES



FEATURES

- Simple push-pull action to connect and disconnect lines-no tools required.
- Plug and body are available valved or unvalved. valves automatically open when connected and shut off when disconnected to minimize the loss of liquids or gases.

TABLE OF DIMENSIONS

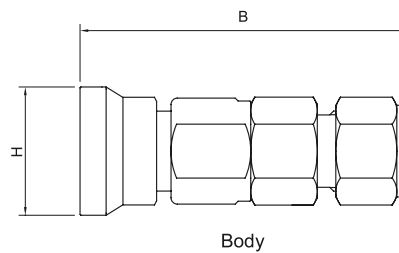
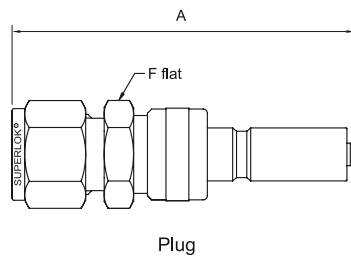

Unit : mm

Unit : mm

Ordering Number		Cv		End Connection		A		F	Ordering Number		End Connection		B	H	
Plug Series	Part no.	SO	DO	Type	SO	DO	Body Series		Part no.	Type					
SO	DO														
SQC1- SO-PG	SQC1- DO-PG	S	2	0.08	0.08	1/8" Superlok	70.4	15.9	SQC1-BY	S	2	1/8" Superlok	57.4	23.1	
			4			1/4" Superlok	61.5				4	1/4" Superlok	58.4		
			6M			6mm Superlok					6M	6mm Superlok			
	M	2N	0.4	0.2	1/8" Male NPT	54.1	M			2N	1/8" Male NPT	51.1			
		4N(R)			1/4" Male NPT(PT)	57.9				4N(R)	1/4" Male NPT(PT)	56.9			
		F			2N	1/8" Female NPT				52.6	F	2N	1/8" Female NPT		
4N(R)	1/4" Female NPT(PT)		58.9	4N(R)	1/4" Female NPT(PT)	61.5									
SQC2- SO-PG	SQC2- DO-PG	S	6	1.5	0.5	3/8" Superlok	67.1	19.1	SQC2-BY	S	6	3/8" Superlok	65.5	26.2	
			10M			10mm Superlok	70.4				10M	10mm Superlok	68.1		
			4N			1/4" Male NPT	61.9				4N	1/4" Male NPT			
	M	6N(R)	1.6	0.5	3/8" Male NPT(PT)		M			6N(R)	3/8" Male NPT(PT)	60.5			
		F	4N	1.5	0.5	1/4" Female NPT				62.7	F	4N	1/4" Female NPT		64.5
			6N(R)	1.6	0.5	3/8" Female NPT(PT)				22.2		6N(R)	3/8" Female NPT(PT)		65.3
SQC3- SO-PG	SQC3- DO-PG	S	8	3.3	1.5	1/2" Superlok	80.3	23.8	SQC3-BY	S	8	1/2" Superlok	78.5	30.7	
			12M			12mm Superlok						12M			12mm Superlok
	M	8N(R)	3.1	1.3	1/2" Male NPT(PT)	77.2	M			8N(R)	1/2" Male NPT(PT)	75.4			
		8N(R)			1/2" Female NPT(PT)	76.7				8N(R)	1/2" Female NPT(PT)	81.8			

• SO : Single shutoff type • DO : Double shutoff type

MATERIALS OF CONSTRUCTION

Component	Material	
Body	316 SS	
Housing		
Double shut off stem		
Double shut off stem retainer		
Body valve		
Body insert		
Single shut off stem retainer		
O-ring		Viton
Spring		304 SS
Body sleeve	316 SS	
Plug sleeve		
Locking Balls		

INSERTION DEPTH

Series	Depth, in.(mm)	
	SO	DO
SQC - 01	1.09(27.7)	1.15(29.2)
SQC - 02	1.18(30.0)	1.30(33.0)
SQC - 03	1.48(37.6)	1.68(42.7)

SPILLAGE

Spillage is the amount of system fluid that escapes when a quick-connect is uncoupled (double shut off only)

Series	SPILLAGE
SQC 1	0.3 cm ³
SQC 2	1.0 cm ³
SQC 3	3.0 cm ³

ORDERING INFORMATION

LOK-SQC - DO - PG - S - 6 - SS

1
2
3
4

1 Body Series

SQC1 - BY
SQC2 - BY
SQC3 - BY

Plug Series

SQC1 - SO - PG / SQC1 - DO - PG
SQC2 - SO - PG / SQC2 - DO - PG
SQC3 - SO - PG / SQC3 - DO - PG

• SO : Single shutoff type • DO : Double shutoff type

2 End Connection

S : SUPERLOK Tube Fitting
F : Female Thread
M : Male Thread

3 End Connection Size

- Tube O.D Designation

Tube O.D (inch)	1/4	3/8	1/2
Designation	4	6	8
Tube O.D (mm)	6	10	12
Designation	6M	10M	12M

4 Body Material

SS : 316 Stainless Steel
B : Brass

PRESSURE-TEMPERATURE RATINGS

Temperature °F (°C)	316 SS with Fluorocarbon FKM O-ring		
	SQC 1	SQC 2	SQC 3
	Pressure Rating, coupled, psig (bar)		
70 (20)	3000 (206)	1500 (103)	750 (51.6)
400 (204)	250 (17.2)		

MAXIMUM FLOW RATE

water at 70°F(20°C)

Series	SQC 1	SQC 2	SQC 3
U.S gal/min	4	6	10
L/min	15	22	37

OVERALL LENGTH

To calculate overall length in the coupled position, subtract the insertion depth from any overall plug and body combination length

OPTION

BODY & PLUG PROTECTOR

Body & Plug Protectors guard against damage and contaminants when bodies and plug are uncoupled.

Series	Ordering Number	
	Body Protector	Plug Protector
SQC 1	SQC1 - BP	SQC1 - PP
SQC 2	SQC2 - BP	SQC2 - PP
SQC 3	SQC3 - BP	SQC3 - PP

- Pipe Thread Designation

Size (inch)	1/8	1/4	3/8	1/2
Screwed BSPT	2R	4R	6R	8R
Screwed NPT	2N	4N	6N	8N

FULL FLOW QUICK - CONNECTS

SFQC SERIES



FEATURES

- Proven ball - lock mechanism provides positive connection.
- Simple push - pull action to connect and disconnect lines - no tools required.
- Compact coupling offers full without orifice restrictions.
- O-ring is easily replaced without disassembling body.

TABLE OF DIMENSIONS

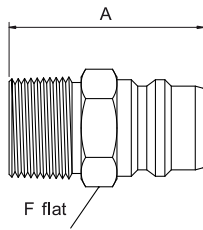

Plug

Unit : mm

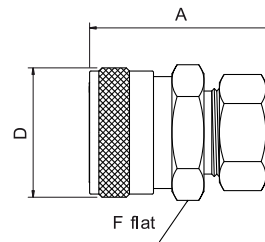

Body

Unit : mm

Ordering Number		End Connection		Cv	Min Orifice	A	F		
Body Series	Part no.	Type	Type						
SFQC2-PG	S	4	1/4 " Superlok	2.2	4.8	45.0	14.3		
	S	6	3/8 " Superlok	2.8			17.5		
	M	4N(R)	1/4 " Male NPT	1.7	6.1	40.4	14.3		
	M	6N(R)	3/8 " Male NPT(PT)				17.5		
	M	4G	1/4 " Male PF			40.6	19.1		
	F	4N(R)	1/4 " Female NPT(PT)			42.4	22.2	40.6	19.1
	F	6N(R)	3/8 " Female NPT(PT)						
	F	4G	1/4 " Female PF						

Ordering Number		End Connection		Min Orifice	A	D	F	
Body Series	Part no.	Type	Type					
SFQC2-BY	S	4	1/4 " Superlok	4.8	45.7	22.2	17.5	
	S	6	3/8 " Superlok	7.1	46.0			
	M	4N(R)	1/4 " Male NPT	6.4	40.0		19.1	
	M	6N(R)	3/8 " Male NPT(PT)	9.4	45.7			
	M	4G	1/4 " Male PF	6.1	45.7		38.1	22.2
	F	4N(R)	1/4 " Female NPT(PT)	9.7	41.4			
	F	6N(R)	3/8 " Female NPT(PT)					
	F	4G	1/4 " Female PF					

Dimensions are for refrence only and are subject to change.

FULL FLOW QUICK - CONNECTS

SFQC SERIES

MATERIALS OF CONSTRUCTION

Component	Material	
	316 SS	Brass
Body	316 SS	Brass
Sleeve		
Locking ball		
Spring	Viton	NBR
Sanp ring		
O - ring	316 SS	Brass
Plug		

PRESSURE-TEMPERATURE RATINGS

Temperature °F (°C)	316 SS with Viton O - ring				Brass with NBR O - ring			
	SFQC 2	SFQC 3	SFQC 4	SFQC 5	SFQC 2	SFQC 3	SFQC 4	SFQC 5
	Pressure Rating, coupled, psig (bar)							
70 (20)	6000 (413)		4000 (275)		4000 (275)	3000 (206)		2000 (137)
250 (121)						100 (6.8)		
400 (204)					100 (6.8)			

INSERTION DEPTH

Series	Depth, in (mm)
SFQC2	0.78 (19.8)
SFQC3	0.81 (20.6)
SFQC4	0.90 (23.0)
SFQC5	0.94 (23.9)

OPTION

BODY & PLUG PROTECTOR

Body & Plug Protectors guard against damage and contaminants when bodies and plug are uncoupled.

Series	Ordering Number	
	Body Protector	Plug Protector
SFQC 2	SFQC2 - BP	SFQC2 - PP
SFQC 3	SFQC3 - BP	SFQC3 - PP
SFQC 4	SFQC4 - BP	SFQC4 - PP
SFQC 5	SFQC5 - BP	SFQC5 - PP

ORDERING INFORMATION

LOK-SQC4 - BY - M - 12N - SS

1 2 3 4

- 1** **Body Series** **Plug Series**
 SFQC2 - BY SFQC2 - PG
 SFQC3 - BY SFQC3 - PG
 SFQC4 - BY SFQC4 - PG
 SFQC5 - BY SFQC5 - PG

- 2** **End Connection**
 S : SUPERLOK Tube Fitting
 F : Female Thread
 M : Male Thread

- 3** **End Connection Size**
 - Tube O.D Designation

Tube O.D (inch)	1/4	3/8	1/2	3/4	1
Designation	4	6	8	12	4
Tube O.D (mm)	6	10	12	20	25
Designation	6M	10M	12M	20M	25M

- Pipe Thread Designation

Size (inch)	1/4	3/8	1/2	3/4	1
Screwed BSPT	4R	6R	8R	12R	16R
Screwed NPT	4N	6N	8N	12N	16N
Screwed BSPP	4G	6G	8G	12G	16G

- 4** **Body Material**
 SS : 316 Stainless Steel
 B : Brass

AUSTRALIA

STAUFF Corporation Pty. Ltd.
P. O. Box 227
Unanderra, NSW, 2526
24-26 Doyle Avenue
Unanderra, Wollongong, NSW, 2526
Tel.: +61 2 4271 18 77
Fax: +61 2 4271 84 32
sales@stauff.com.au

BRAZIL

STAUFF Brasil Ltda.
Avenida Gupê 10767
Galpão 2 - Bloco A
Barueri - São Paulo
CEP 06422-120
Tel.: +55 11 47 72 72 00
Fax: +55 11 47 72 72 10
stauff@stauffbrasil.com

CANADA

STAUFF Canada Ltd.
866 Milner Avenue
Scarborough
Ontario M1B 5N7
Tel.: +1 416 282 46 08
Fax: +1 416 282 30 39
sales@stauffcanada.com

CHINA

STAUFF International Trading
(Shanghai) Co., Ltd.
No. 41-42, Lane 369, Chuang Ye Road
Jushuo Industrial Zone, Kang Qiao
Shanghai, 201319
Tel.: +86 21 68 18 70 00
Fax: +86 21 68 18 71 36
info@stauff.com.cn

FRANCE

STAUFF S.A.S.
230, Avenue du Grain d'Or
Z.I. de Vineuil - Blois Sud
41354 Vineuil-cedex
Tel.: +33 2 54 50 55 50
Fax: +33 2 54 42 29 19
direction@stauffsa.com

INDIA

STAUFF India Pvt. Ltd.
Gat. No. 2340
Pune Nagar Road, Wagholi
Pune, 412207
Tel.: +91 20 6620 2473
Fax: +91 20 2705 1567
sales@stauffindia.com

ITALY

STAUFF Italia s.r.l.
Viale Nuova Valassina 78
angolo Via Baragiola sn
20033 Desio (MI)
Tel.: +39 0362 63 80 70
Fax: +39 0362 63 80 69
sales@stauff.it

IRELAND

STAUFF Ireland Ltd.
Unit B3
Weatherwell Business Park
Clondalkin
Dublin 22
Tel.: +353 1457 4936
Fax: +353 1467 0687
sales@stauff.ie

KOREA

STAUFF Korea Ltd.
1500-12, Dadae-Dong
Saha-Ku
Pusan, 604-826
Tel.: +82 51 266 6666
Fax: +82 51 266 8866
info@stauff.co.kr

NEW ZEALAND

STAUFF Corporation (NZ) Ltd.
P. O. Box 58517
Greenmount, Auckland
Unit D, 103 Harris Road
East Tamaki, Auckland
Tel.: +64 9 271 48 12
Fax: +64 9 271 48 32
info@stauff.co.nz

POLAND

STAUFF Polska Sp. z o.o.
Miszewko 43 A
80-297 Banino
Tel.: +48 58 660 11 60
Fax: +48 58 629 79 52
sales@stauff.pl

RUSSIAN FEDERATION

STAUFF LLC
Office 205, Building 7
Scharikopodschipnikovskaya 11
Moscow, 115088
Tel.: +7 495 987 36 29
+7 495 223 89 61
Fax: +7 495 679 90 48
sales@stauff.ru

UNITED KINGDOM

STAUFF UK
500, Carlisle Street East
Off Downgate Drive
Sheffield, S4 8BS
Tel.: +44 114 251 85 18
Fax: +44 114 251 85 19
sales@stauff.co.uk

UNITED STATES

STAUFF Corporation
7 Wm. Demarest Place
Waldwick, 07463-1542
New Jersey
Tel.: +1 201 444 78 00
Fax: +1 201 444 78 52
sales@stauffusa.com

Globally available through wholly-owned branches and distributors in all industrial countries.

GERMANY
WALTER STAUFFENBERG GmbH & Co. KG

P. O. Box 1745
D-58777 Werdohl
Im Ehrenfeld 4
D-58791 Werdohl
Tel.: +49 23 92 916-0
Fax: +49 23 92 2505
filtrationtechnology@stauff.com
www.stauff.com