



Swing - Out Ball Valves

High Technology Valve & Fitting Series



SWB 310 SERIES

SPECIFICATION

- Pressure Rating up to 1000 psig (69 bar) at 100 °F (37 °C)
- Temperature Range from -20 °F (-28 °C) to 450 °F (232 °C)

TESTING

- Each valve is tested with nitrogen at 1000 psig (69 bar) to maximum allowable leak rate of 0.1 SCCM.
- Hydrostatic shell test is performed at 1.5 times the working pressure.

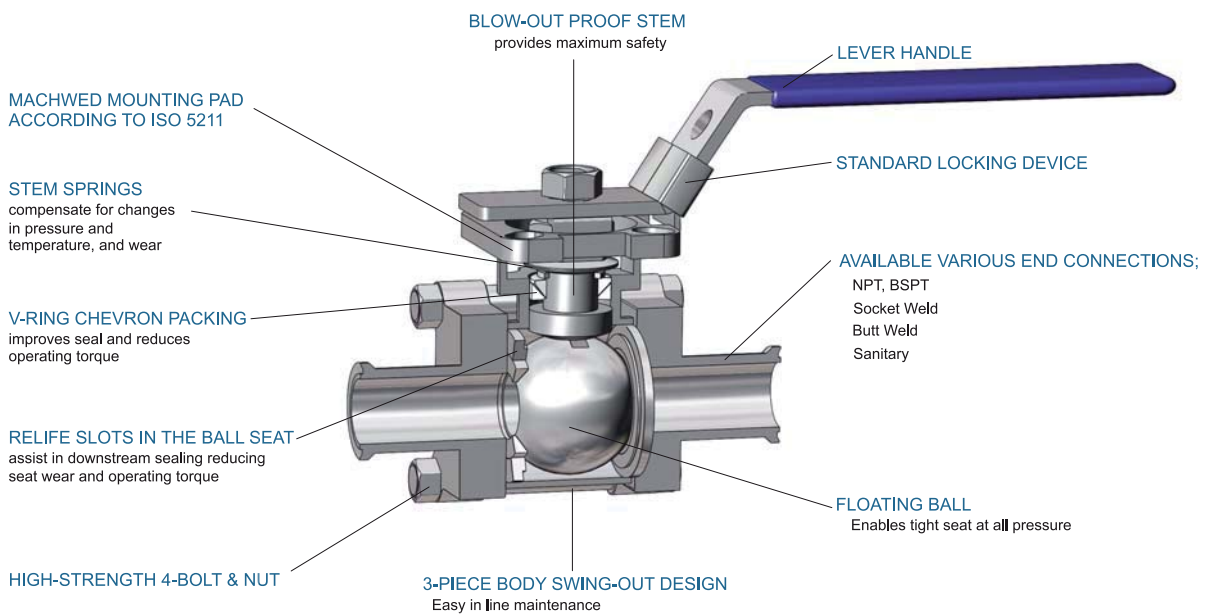
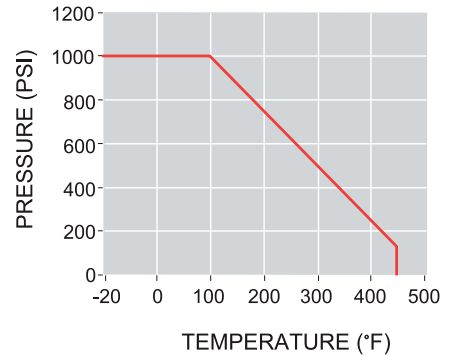

MATERIALS OF CONSTRUCTION

Component	Material	Q' TY
1 Body	ASTM A351GR/CF8M	1
2 End Cap	ASTM A351GR/CF8M	2
3 Ball	SS 316	1
4 Ball Seal	PTFE	2
5 Flange Seal	PTFE	2
6 Stem	SS316	1
7 Stem Seal	PTFE	1
8 Upper/Lower Packing	PTFE	1
9 Packing Gland	SS304	1
10 Handle Nut	STRAIN HARDNED 316	1
11 Disc Spring	SS304	2
12 Stem Nut	SS304	1
13 Handle	SS304	1
14 Locking Device	SS304	1
15 Stem Nut Lock	SS304	1
16 Flange Bolt	SS304	4
17 Flange Nut	SS304	4

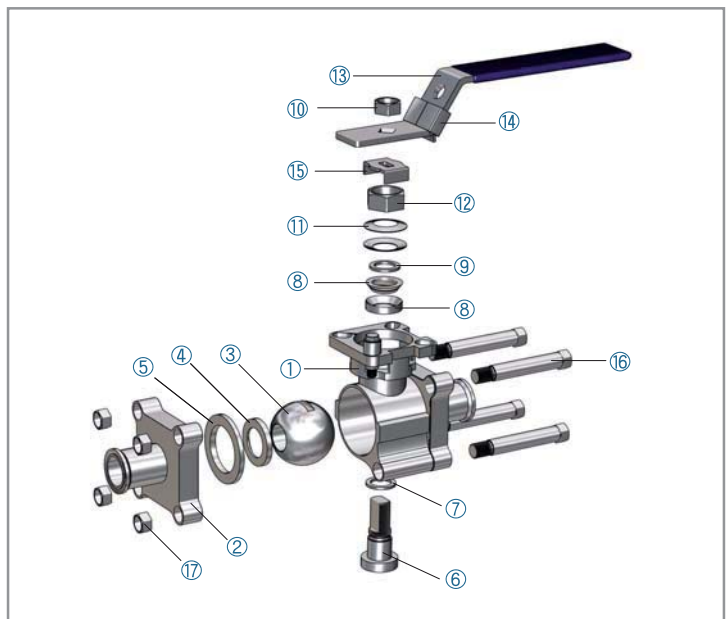
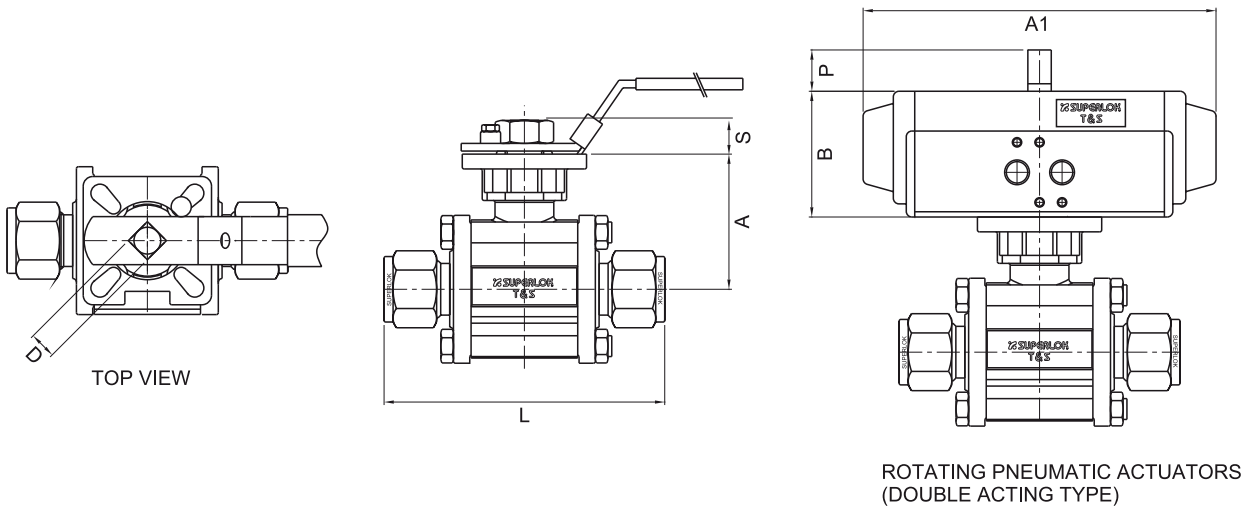
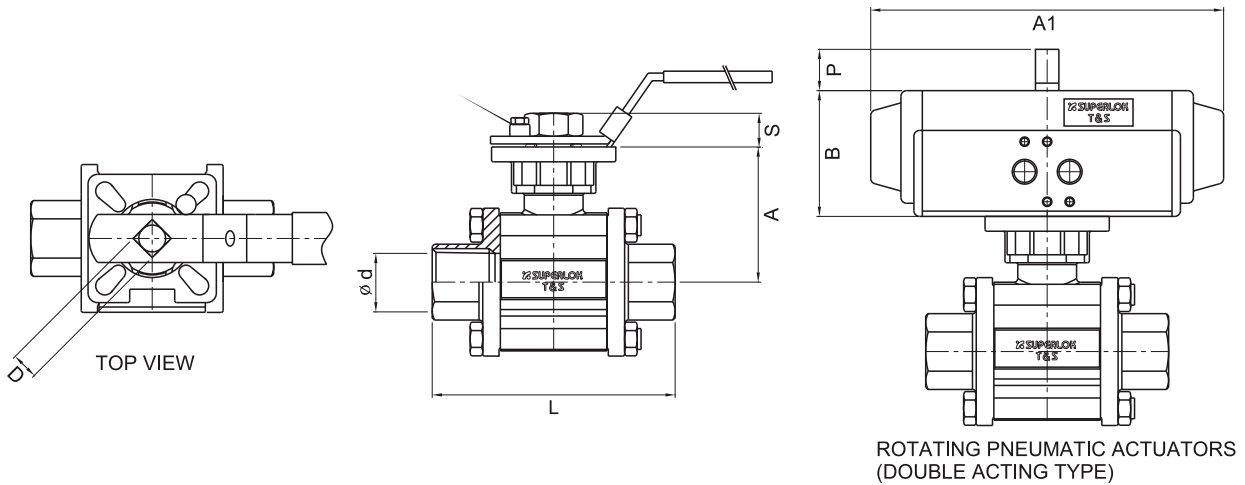

TABLE OF DIMENSIONS



■ SUPERLOK TUBE END CONNECTIONS

Ordering Number		SIZE	Dimension (mm)								
Series	Part NO.		A	S	D	L	A1	B	P		
LOK-SWB	3101	SW	4	1/4 " SUPERLOK	39.0	8.5	9	72.6	188	67	20
			6	3/8 " SUPERLOK				74.2			
			8	1/2 " SUPERLOK				75.6			
	3102	12	3/4 " SUPERLOK	43.0	86.0						
	3103	16	1 " SUPERLOK	53.0	11.4	104.0					



■ FEMALE PIPE THREAD END CONNECTIONS

Ordering Number		SIZE	Dimension (mm)									
Series	Part NO.		A	S	D	$\varnothing d$	L	A1	B	P		
LOK-SWB	3101	F	4N	1/4 "	39.0	8.5	9	11.5	188	67	20	
			6N	3/8 "				12.5				63.5
			8N	1/2 "				15.0				
	3102	12N	3/4 "	43.0	20.0	72.5						
	3103	16N	1 "	53.0	11.4	25.0	81.0					
	3104	24N	1-1/2 "	70.0	14.0	11	38.0	108.0	234	86		
	3105	32N	2 "	78.0	13.7	14	50.0	121.5				

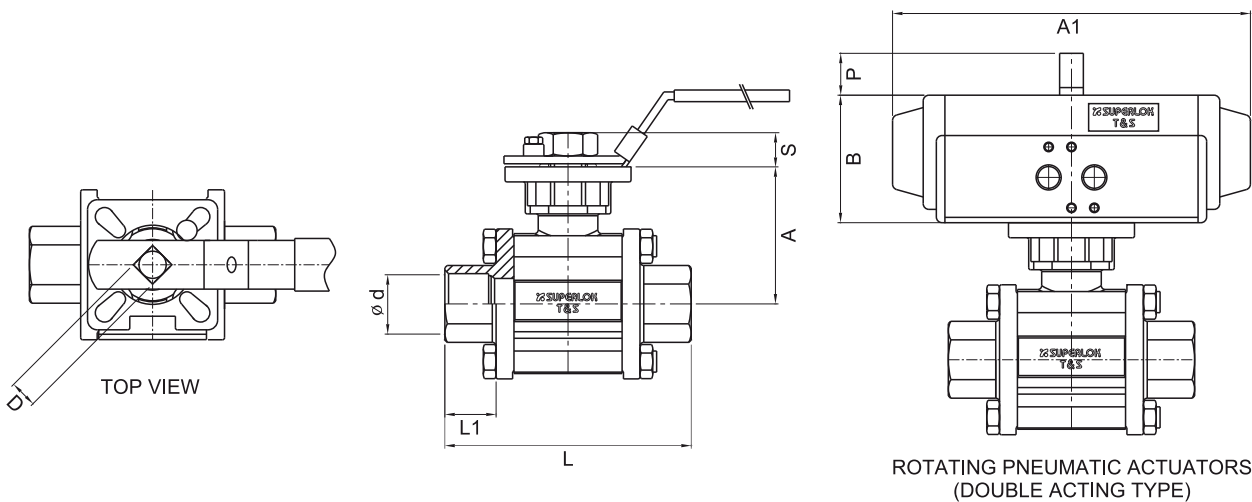

ROTATING PNEUMATIC ACTUATORS
(DOUBLE ACTING TYPE)

SOCKET WELD END CONNECTIONS

Ordering Number			Dimension (mm)										
Series	Part NO.	SIZE	A	S	D	ø d	L	L1	A1	B	P		
LOK-SWB	3101	SW	4	1/4"	39.0	8.5	9	14.1	63.5	10	188	67	20
			6	3/8"				17.6					
			8	1/2"				21.7					
	3102	3103	12	3/4"	43.0	11.4	27.3	72.5	13	234	86		
	16		1"	53.0	34.1	81.0							
	24		1 1/2"	70.0	14.0	11	48.7	108.0					
3105		32	2"	78.0	13.7	14	61.0	121.5	16				

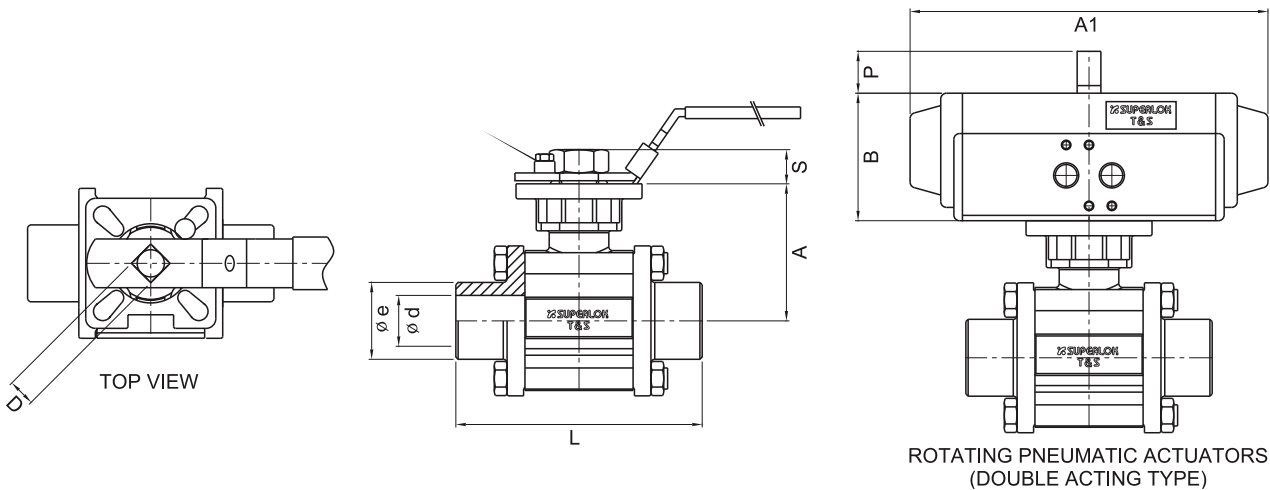

ROTATING PNEUMATIC ACTUATORS
(DOUBLE ACTING TYPE)

BUTT WELD END CONNECTIONS

Ordering Number			Dimension (mm)										
Series	Part NO.	SIZE	A	S	D	ø d	L	ø e	A1	B	P		
LOK-SWB	3101	BW	4	1/4"	39.0	8.5	9	11.6	62.5	16.2	188	67	20
			6	3/8"				12.7		17.5			
			8	1/2"				15.0		22.7			
	3102	3103	12	3/4"	43.0	11.4	20.0	76.2	27.5	234	86		
	16		1"	53.0	25.0	86.0	33.5						
	24		1 1/2"	70.0	14.0	11	38.0	119.0	48.6				
3105		32	2"	78.0	13.7	14	50.0	131.4	60.5				

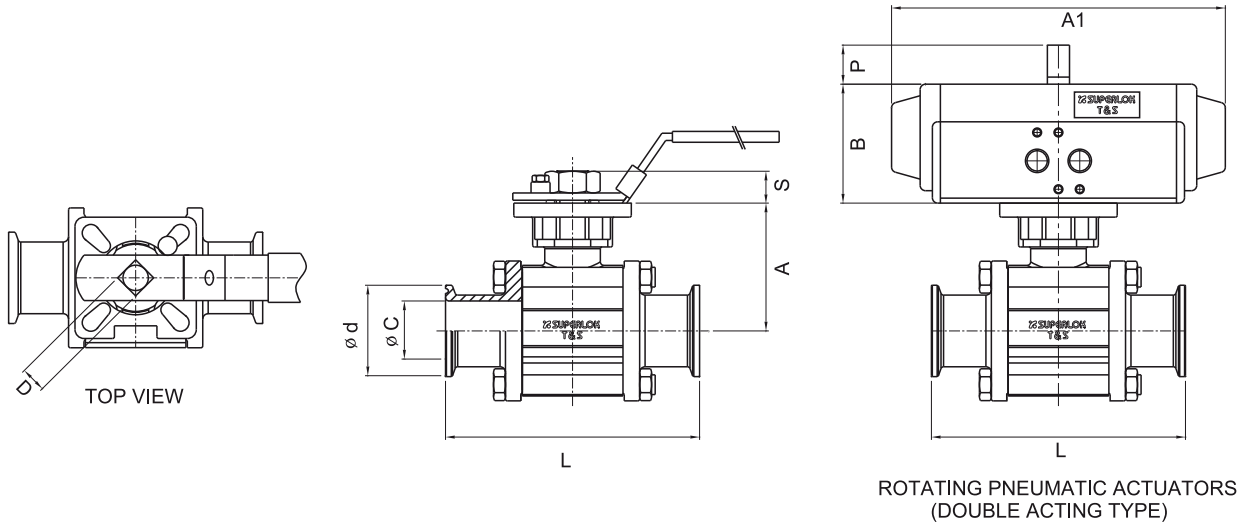

SANITARY END CONNECTIONS

Ordering Number			SIZE	Dimension (mm)									
Series	Part NO.			A	S	L	ϕC	ϕd	D	A1	B	P	
LOK-SWB	3101	SA	8	1/2 "	39.0	9	89.0	9.5	25.4	9	188	67	20
	3102		12	3/4 "	43.0	9	102.0	13.1	25.4	9			
	3103		16	1 "	53.0	11	124.0	22.2	50.4	11			
	3104		24	1 1/2 "	70.0	14	141.0	35.0	50.4	14	234	86	
	3105		32	2 "	78.0	14	162.0	47.6	63.9	14			

OPTIONS

ACTUATION

We can provide pneumatic actuation package as optional item with following features

- Direct mounted actuator
- Reducing package device
- ※ If require actuator as option, add A to the end of ordering number
Ex)SWB3105-SA-32-A

BODY CAVITY FILLERS

Body cavity fillers are designed to fill the cavity of the valve between the body and ball.

Cavity fillers minimize problems with trapped fluid in the valve body that could contaminate the process or prevent smooth operation of the valve.

- ※ If require body cavity filler as option, add BCF to the end of ordering number
Ex)SWB3105-SA-32-BCF

SWB 320 SERIES

SPECIFICATION

- Pressure Rating up to 3000 psig (206 bar) at 100 °F (37 °C)
- Temperature Range from -20 °F (-28 °C) to 450 °F (232 °C)

TESTING

- Each valve is tested with nitrogen at 1000 psig (69 bar) to maximum allowable leak rate of 0.1 SCCM.
- Hydrostatic shell test is performed at 1.5 times the working pressure.

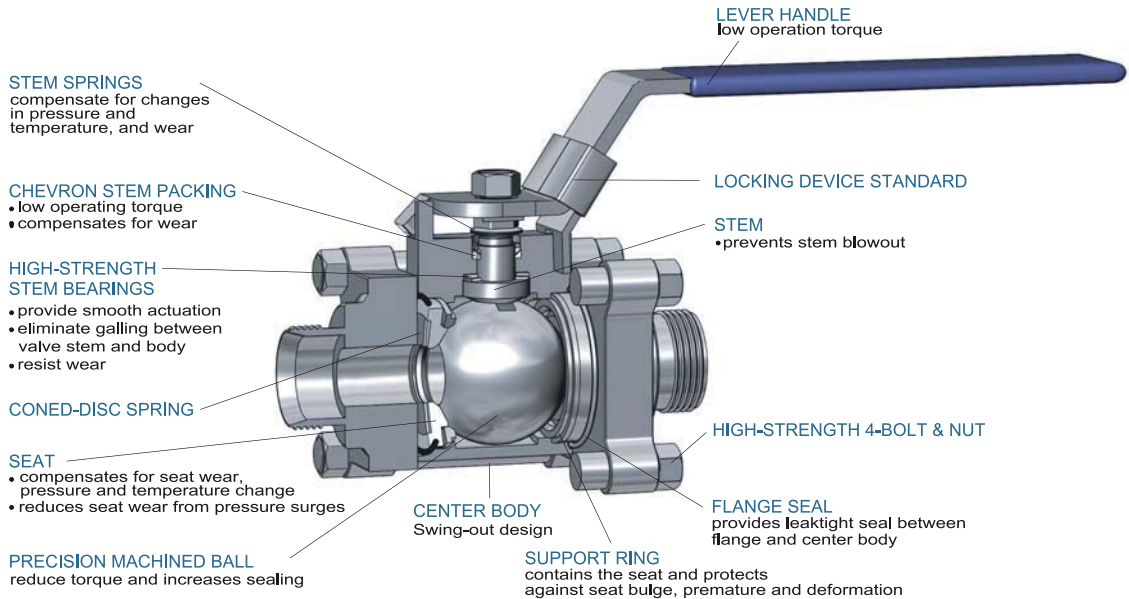

PRESSURE/TEMPERATURE RATING

■ REINFORCED PTFE SEATS (R-PTFE) : STANDARD

Series	Pressure - Temperature Rating	
	Temperature °F (°C)	Working Pressure psig (bar)
SWB 320	-20 to 100 (-28 to 37)	2200 (151)
	150 (65)	1850 (127)
	200 (93)	1500 (103)
	250 (121)	1150 (79.2)
	300 (148)	800 (55.1)
	350 (176)	560 (38.5)
	400 (204)	330 (22.7)
	450 (232)	100 (6.8)

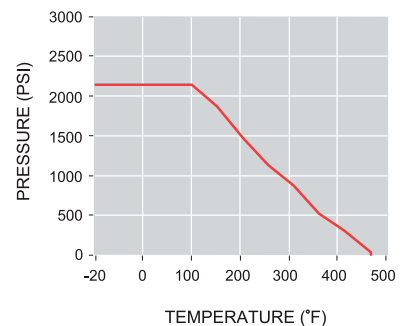

■ CARBON / GLASS PTFE SEATS : OPTION

Series	Pressure - Temperature Rating	
	Temperature °F (°C)	Working Pressure psig (bar)
SWB 320	-20 to 100 (-28 to 37)	2500 (172)
	150 (65)	2430 (167)
	200 (93)	1870 (128)
	250 (121)	1620 (111)
	300 (148)	1240 (85.4)
	350 (176)	860 (59.2)
	400 (204)	480 (33.0)
	450 (232)	100 (6.8)

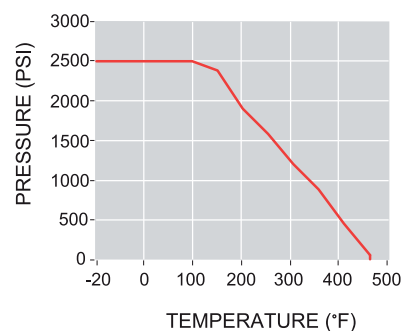

To order option item, add C to the end of ordering number.

PRESSURE/TEMPERATURE RATING

PEEK SEATS : OPTION

Series	Pressure - Temperature Rating	
	Temperature °F (°C)	Working Pressure psig (bar)
SWB 320	-20 to 100 (-28 to 37)	3000 (206)
	150 (65)	2420 (166)
	200 (93)	1870 (128)
	250 (121)	1770 (121)
	300 (148)	1600 (110)
	350 (176)	1430 (98.5)
	400 (204)	1260 (86.8)
	450 (232)	800 (55.1)

To order option item, add P to the end of ordering number.

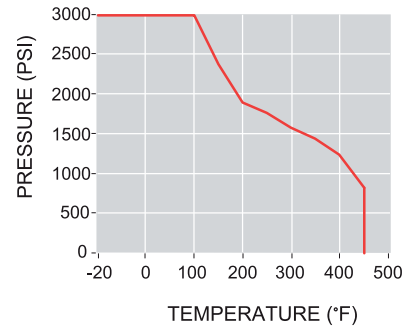

VIRGIN PTFE SEATS : OPTION

Series	Pressure - Temperature Rating	
	Temperature °F (°C)	Working Pressure psig (bar)
SWB 320	-20 to 100 (-28 to 37)	1500 (103)
	150 (65)	1500 (103)
	200 (93)	1500 (103)
	250 (121)	1150 (79.2)
	300 (148)	800 (55.1)
	350 (176)	560 (38.5)
	400 (204)	330 (22.7)
	450 (232)	100 (6.8)

To order option item, add V to the end of ordering number.

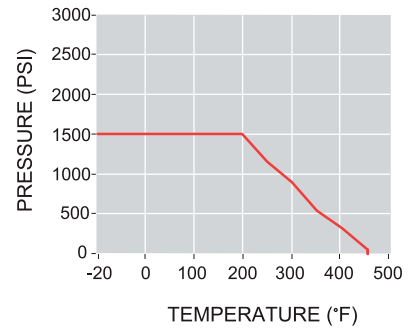

MATERIALS OF CONSTRUCTION

Component	Valve Body Materials		Q / TY
	Material / ASTM Specification		
1	Body	CF8M / A351	1
2	Ball	SS 316 / A479	1
3	Support ring	SS 316 / A479	2
4	Seats	Reinforced PTFE	2
5	Seat spring	Strain Hardned 316 SS / A240	2
6	Flange seal	PTFE	2
7	Flange	CF8M / A351 or SS 316 / A479	2
8	Stem	SS 316 / A479	1
9	Stem bearing	Alloy X750	1
10	Lower packing	Reinforced PTFE	1
11	Upper packing		1
12	Packing support	PEEK	1
13	Packing gland	SS 316 / A479	1
14	Stem spring	Strain Hardned 316	2
15	Packing nut	Stainless Steel	2
16	Stem nut lock		1
17	Handle		1
18	Locking device		1
19	Tooth washer		1
20	Flange bolt	SS304	4
21	Flange nut	SS304	4

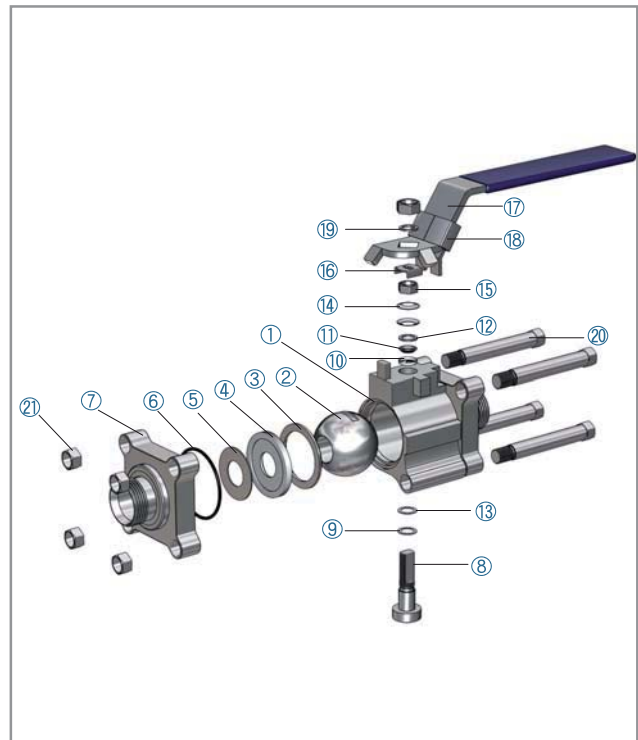
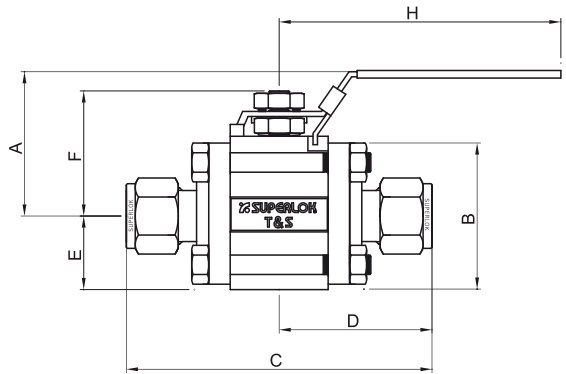
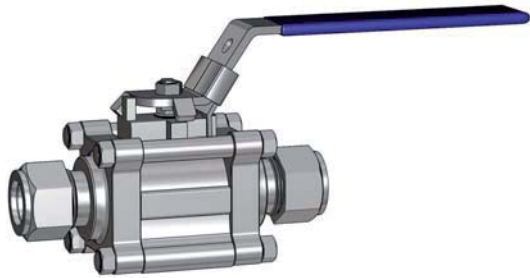
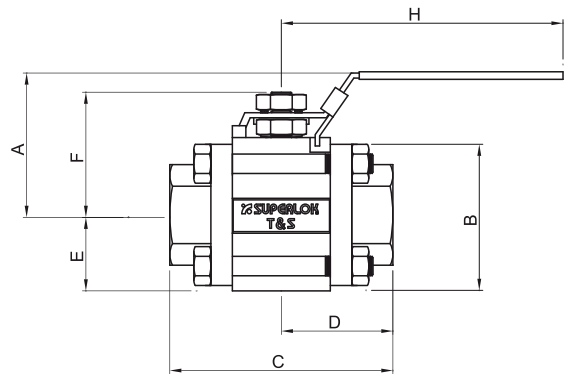
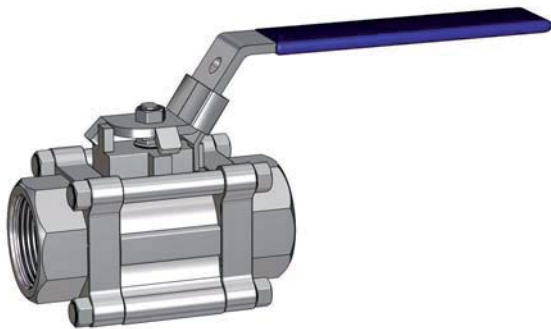

TABLE OF DIMENSIONS



■ SUPERLOK TUBE END CONNECTION

Ordering Number		Orifice in. (mm)	Cv	End Connection	Dimension (mm)							
Series	Part NO.				A	B	C	D	E	F	H	
LOK- SWB3201	S	4	0.188 (4.8)	1.2	1/4 " Superlok	47.7	33.0	80.8	40.40	16.75	31.8	57.2
		6	0.281 (7.1)	3.8	3/8 " Superlok							
		6M	0.188 (4.8)	1.2	6mm Superlok							
		8M	0.250 (6.4)	2.5	8mm Superlok							
LOK- SWB3202	S	10M	0.281 (7.1)	3.8	10mm Superlok	64.8	44.5	103.8	51.90	22.25	44.2	111.0
		8	0.411 (10.4)	7.5	1/2 " Superlok							
		12	0.516 (13.1)	13.6	3/4 " Superlok							
LOK- SWB3203	S	12M	0.411 (10.4)	7.5	12mm Superlok	79.0	62.0	136.7	68.35	31.0	61.9	149.4
		16	0.875 (22.2)	40.0	1 " Superlok							
		25M					25mm Superlok					



■ FEMALE PIPE THREAD END CONNECTIONS

Ordering Number		Orifice in. (mm)	Cv	End Connection	Dimension (mm)							
Series	Part NO.				A	B	C	D	E	F	H	
LOK- SWB3201	F	2N	0.281 (7.1)	3.8	1/8 " Female NPT	47.7	33.0	55.4	27.70	16.75	31.8	57.2
		4N			1/4 " Female NPT							
		4R			1/4 " Female PT							
LOK- SWB3202	F	6N	0.516 (13.1)	12.0	3/8 " Female NPT	64.8	44.5	68.9	34.45	22.25	44.2	111.0
		8N			1/2 " Female NPT							
		8R			1/2 " Female PT							
LOK- SWB3203	F	12N	0.875 (22.2)	40.0	3/4 " Female NPT	79.0	62.0	92.0	46.0	31.0	61.9	149.4
		16N			1 " Female NPT							
		12R			3/4 " Female PT							
		16R			1 " Female PT							

TABLE OF DIMENSIONS

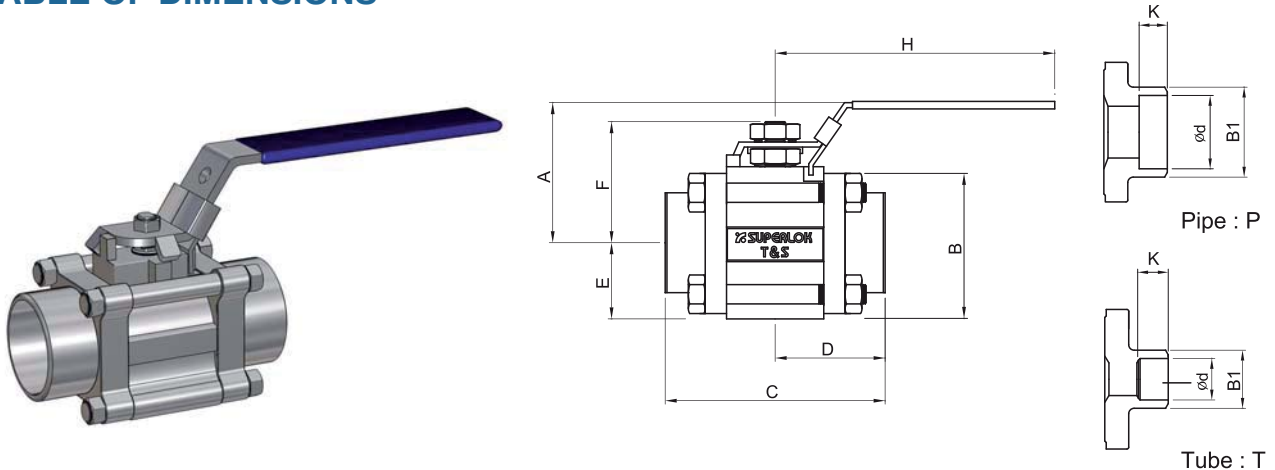

■ SOCKET WELD END CONNECTIONS

Ordering Number		Orifice in. (mm)	Cv	End Connection	Dimension (mm)										
Series	Part NO.				ø d	B1	A	B	C	D	E	F	H	K	
LOK-SWB3201	SW	4T	0.188 (4.8)	1.2	1/4 " Soket Weld	6.50	13.70	47.7	33.0	55.4	27.70	16.75	31.8	57.2	7.1
		6T	0.281 (7.1)	3.8	3/8 " Soket Weld	9.70	17.10								7.9
LOK-SWB3202	SW	8T	0.411 (10.4)	7.5	1/2 " Soket Weld	12.90	21.30	64.8	44.5	68.9	34.45	22.25	44.2	111.0	9.7
		12T	0.516 (13.1)	13.6	3/4 " Soket Weld	19.20	26.70								11.2
LOK-SWB3203	SW	8P	0.516 (13.1)	15.0	1/2 " Soket Weld	21.80	31.20	79.0	62.0	92.0	46.00	31.00	61.9	149.4	9.7
		16T	0.875 (22.2)	40.0	1 " Soket Weld	25.65	33.40								16.0
		12P		36.0	3/4 " Soket Weld	27.20	42.16								12.7
		16P	42.0	1 " Soket Weld	33.90	45.30									

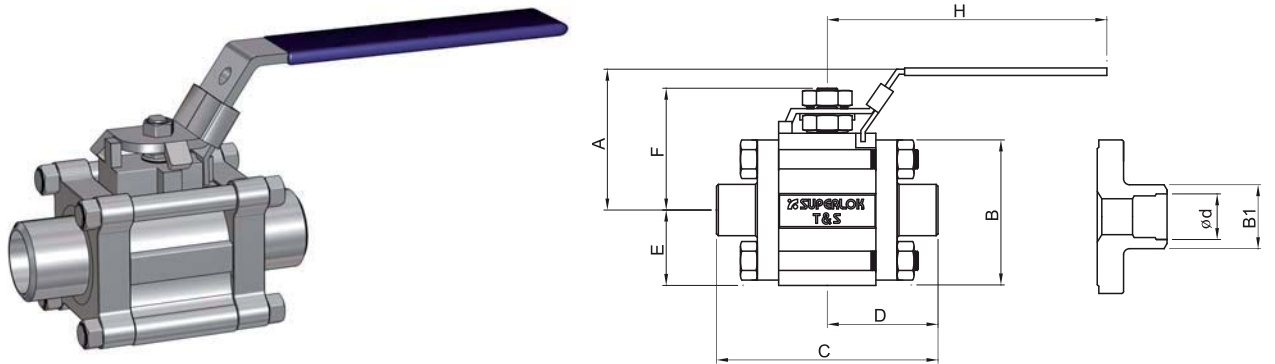

■ BUTT WELD END CONNECTIONS

Ordering Number		Schedule	Orifice in. (mm)	Cv	End Connection	Dimension (mm)										
Series	Part NO.					ø d	B1	A	B	C	D	E	F	H		
LOK-SWB3201	4P	10	0.188 (4.8)	1.2	1/4 " Butt Weld	10.40	13.70	47.7	33.0	52.4	26.20	16.75	31.8	57.2		
LOK-SWB3202	8P		0.516 (13.1)	15.0	1/2 " Butt Weld	17.10	21.30								64.8	44.5
LOK-SWB3203	12P		0.875 (22.2)	36.0	3/4 " Butt Weld	22.45	26.67	79.0	62.0	92.0	46.00	88.9	44.45	31.0	61.9	149.4
LOK-SWB3203	16P		40.0	1 " Butt Weld	27.90	33.40										
LOK-SWB3201	4P	40	0.188 (4.8)	1.2	1/4 " Butt Weld	9.20	13.70	47.7	33.0	52.4	26.20	16.75	31.8	57.2		
LOK-SWB3202	8P		0.516 (13.1)	15.0	1/2 " Butt Weld	15.80	21.30								64.8	44.5
LOK-SWB3203	12P		0.875 (22.2)	36.0	3/4 " Butt Weld	20.93	26.67	79.0	62.0	92.0	46.00	88.9	44.45	31.0	61.9	149.4
LOK-SWB3203	16P		40.0	1 " Butt Weld	26.60	33.40										
LOK-SWB3201	4P	80	0.188 (4.8)	1.2	1/4 " Butt Weld	7.70	13.70	47.7	33.0	52.4	26.20	16.75	31.8	57.2		
LOK-SWB3201	6P		0.281 (7.1)	3.8	3/8 " Butt Weld	10.70	17.10									
LOK-SWB3202	8P		0.411 (10.4)	7.5	1/2 " Butt Weld	13.90	21.30	64.8	44.5	68.9	34.45	22.25	44.2	111.0		
LOK-SWB3202	12P		0.516 (13.1)	13.6	3/4 " Butt Weld	18.80	26.70									
LOK-SWB3203	16P	0.875 (22.2)	40.0	1 " Butt Weld	23.90	33.40	79.0	62.0	88.9	44.45	31.00	61.9	149.4			

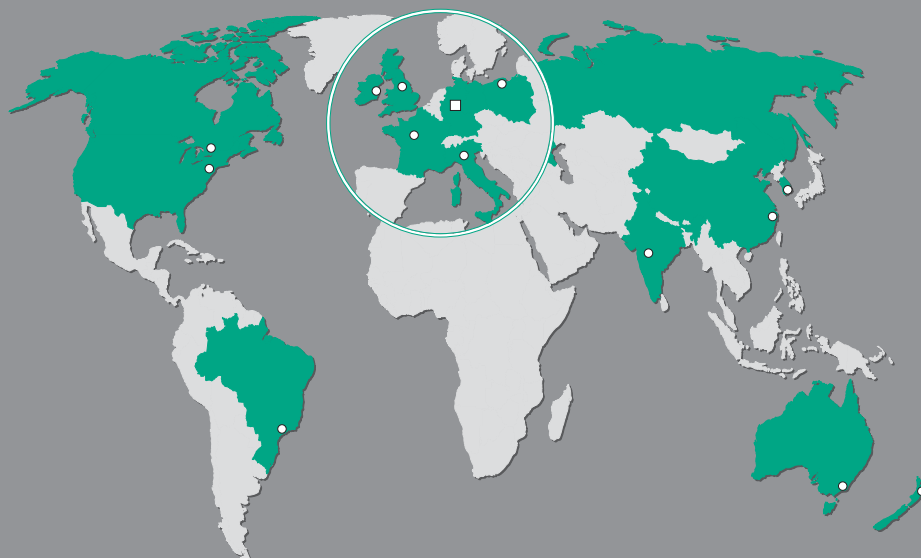
AUSTRALIA

STAUFF Corporation Pty. Ltd.
P. O. Box 227
Unanderra, NSW, 2526
24-26 Doyle Avenue
Unanderra, Wollongong, NSW, 2526
Tel.: +61 2 4271 18 77
Fax: +61 2 4271 84 32
sales@stauff.com.au

BRAZIL

STAUFF Brasil Ltda.
Avenida Gupê 10767
Galpão 2 - Bloco A
Barueri - São Paulo
CEP 06422-120
Tel.: +55 11 47 72 72 00
Fax: +55 11 47 72 72 10
stauff@stauffbrasil.com

CANADA

STAUFF Canada Ltd.
866 Milner Avenue
Scarborough
Ontario M1B 5N7
Tel.: +1 416 282 46 08
Fax: +1 416 282 30 39
sales@stauffcanada.com

CHINA

STAUFF International Trading
(Shanghai) Co., Ltd.
No. 41-42, Lane 369, Chuang Ye Road
Jushuo Industrial Zone, Kang Qiao
Shanghai, 201319
Tel.: +86 21 68 18 70 00
Fax: +86 21 68 18 71 36
info@stauff.com.cn

FRANCE

STAUFF S.A.S.
230, Avenue du Grain d'Or
Z.I. de Vineuil - Blois Sud
41354 Vineuil-cedex
Tel.: +33 2 54 50 55 50
Fax: +33 2 54 42 29 19
direction@stauffsa.com

INDIA

STAUFF India Pvt. Ltd.
Gat. No. 2340
Pune Nagar Road, Wagholi
Pune, 412207
Tel.: +91 20 6620 2473
Fax: +91 20 2705 1567
sales@stauffindia.com

ITALY

STAUFF Italia s.r.l.
Viale Nuova Valassina 78
angolo Via Baragiola sn
20033 Desio (MI)
Tel.: +39 0362 63 80 70
Fax: +39 0362 63 80 69
sales@stauff.it

IRELAND

STAUFF Ireland Ltd.
Unit B3
Weatherwell Business Park
Clondalkin
Dublin 22
Tel.: +353 1457 4936
Fax: +353 1467 0687
sales@stauff.ie

KOREA

STAUFF Korea Ltd.
1500-12, Dadae-Dong
Saha-Ku
Pusan, 604-826
Tel.: +82 51 266 6666
Fax: +82 51 266 8866
info@stauff.co.kr

NEW ZEALAND

STAUFF Corporation (NZ) Ltd.
P. O. Box 58517
Greenmount, Auckland
Unit D, 103 Harris Road
East Tamaki, Auckland
Tel.: +64 9 271 48 12
Fax: +64 9 271 48 32
info@stauff.co.nz

POLAND

STAUFF Polska Sp. z o.o.
Miszewko 43 A
80-297 Banino
Tel.: +48 58 660 11 60
Fax: +48 58 629 79 52
sales@stauff.pl

RUSSIAN FEDERATION

STAUFF LLC
Office 205, Building 7
Scharikopodschipnikovskaya 11
Moscow, 115088
Tel.: +7 495 987 36 29
+7 495 223 89 61
Fax: +7 495 679 90 48
sales@stauff.ru

UNITED KINGDOM

STAUFF UK
500, Carlisle Street East
Off Downgate Drive
Sheffield, S4 8BS
Tel.: +44 114 251 85 18
Fax: +44 114 251 85 19
sales@stauff.co.uk

UNITED STATES

STAUFF Corporation
7 Wm. Demarest Place
Waldwick, 07463-1542
New Jersey
Tel.: +1 201 444 78 00
Fax: +1 201 444 78 52
sales@stauffusa.com

Globally available through wholly-owned branches and distributors in all industrial countries.

GERMANY
WALTER STAUFFENBERG GmbH & Co. KG

P. O. Box 1745
D-58777 Werdohl
Im Ehrenfeld 4
D-58791 Werdohl
Tel.: +49 23 92 916-0
Fax: +49 23 92 2505
filtrationtechnology@stauff.com
www.stauff.com